

Inductive sensor NBB2-F76-E1-0,5M



- 2 mm flush
- 3-wire DC



Dimensions

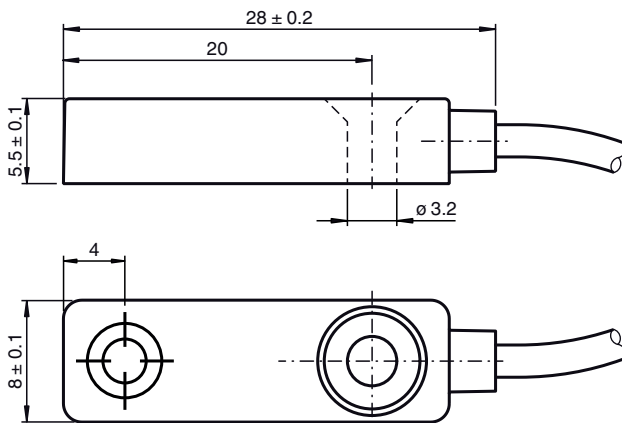

Technical Data

General specifications

Switching function		Normally closed (NC)
Output type		NPN
Rated operating distance	s_n	2 mm
Installation		flush
Output polarity		DC
Assured operating distance	s_a	0 ... 1.62 mm
Reduction factor r_{Al}		0.25
Reduction factor r_{Cu}		0.2
Reduction factor r_{304}		0.63
Reduction factor r_{Brass}		0.31
Output type		3-wire

Nominal ratings

Operating voltage	U_B	10 ... 30 V DC
Switching frequency	f	0 ... 1500 Hz
Hysteresis	H	typ. 5 %
Reverse polarity protection		reverse polarity protected
Short-circuit protection		pulsing

Release date: 2024-05-27 Date of issue: 2024-05-29 Filename: 214956_eng.pdf

Refer to "General Notes Relating to Pepperl+Fuchs Product Information".

Pepperl+Fuchs Group
www.pepperl-fuchs.com

USA: +1 330 486 0001
fa-info@us.pepperl-fuchs.com

Germany: +49 621 776 1111
fa-info@de.pepperl-fuchs.com

Singapore: +65 6779 9091
fa-info@sg.pepperl-fuchs.com

PEPPERL+FUCHS

Technical Data

Voltage drop	U _d	≤ 3 V
Operating current	I _L	0 ... 100 mA
Off-state current	I _r	0 ... 0.5 mA typ. 10 µA at 25 °C
No-load supply current	I ₀	≤ 15 mA
Switching state indicator		LED yellow
Functional safety related parameters		
MTTF _d		828 a
Mission Time (T _M)		20 a
Diagnostic Coverage (DC)		0 %
Compliance with standards and directives		
Standard conformity		
Standards		EN IEC 60947-5-2
Approvals and certificates		
CCC approval		CCC approval / marking not required for products rated ≤36 V
Ambient conditions		
Ambient temperature		-25 ... 70 °C (-13 ... 158 °F)
Mechanical specifications		
Connection type		cablc PVC , 0.5 m
Core cross section		3 x 0.09 mm²
Housing material		PC
Degree of protection		IP67
Mass		5 g
Tightening torque, fastening screws		0.7 Nm
Dimensions		
Height		5.5 mm
Width		8 mm
Length		25 mm

Connection

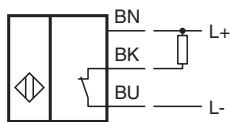

Release date: 2024-05-27 Date of issue: 2024-05-29 Filename: 214956_eng.pdf

Assembly

Important Mounting Note

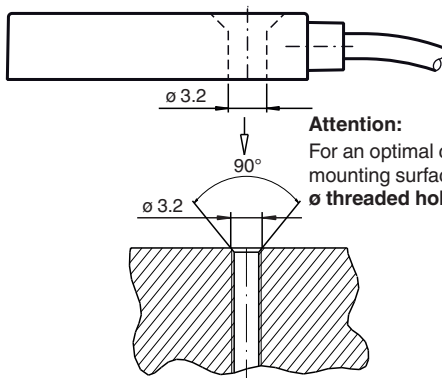

Attention:

For an optimal connection of the sensor via its sleeve with the mounting surface, the following applies:

ø threaded hole on mounting surface (countersink) < ø sleeve

Mounting

Caution:

The diameter of any countersink on the on-site M3 threaded hole must not be greater than 3.2 mm. Only in this way is the shouldering of the sensor's metal insert bushing guaranteed.

Release date: 2024-05-27 Date of issue: 2024-05-29 Filename: 214956_eng.pdf

Refer to "General Notes Relating to Pepperl+Fuchs Product Information".

Pepperl+Fuchs Group
www.pepperl-fuchs.com

USA: +1 330 486 0001
fa-info@us.pepperl-fuchs.com

Germany: +49 621 776 1111
fa-info@de.pepperl-fuchs.com

Singapore: +65 6779 9091
fa-info@sg.pepperl-fuchs.com

 **PEPPERL+FUCHS**